

CAMBOURNE PARISH COUNCIL
District of South Cambridgeshire

Council Meeting 1st December 2015

13. School Lane Street Lighting

Attached is correspondence relating to the proposed changes to the School Lane Street Lighting and commuted sum calculation.

Clarification is being sought on details of the latest email. The Parish Clerk will give a further update if the information is received prior to the meeting.

AGENDA ITEM No. 13.

John Vickery

From: Dillon, Natasha <Natasha.Dillon@bblivingplaces.com>
Sent: 10 November 2015 13:34
To: parishclerk@caldecote.gov.uk; cllr.gavigan@cambourneparishcouncil.gov.uk;
cllr.crocker@cambourneparishcouncil.gov.uk;
cllr.thomashudson@cambourneparishcouncil.gov.uk;
cllr.thomashudson@cambourneparishcouncil.gov.uk;
cllr.masters@cambourneparishcouncil.gov.uk;
cllr.ghazala@cambourneparishcouncil.gov.uk;
cllr.odwyer@cambourneparishcouncil.gov.uk;
cllr.patel@cambourneparishcouncil.gov.uk;
cllr.poulton@cambourneparishcouncil.gov.uk;
cllr.smith@cambourneparishcouncil.gov.uk; clerk@cambourneparishcouncil.gov.uk
Subject: Street Lighting - School Lane, Cambourne
Attachments: School Lane - Cambourne-V1.pdf

Dear Councillor(s),

Balfour Beatty will soon be working in School Lane, Cambourne. Please find attached a copy of the relevant plan(s).

For planning purposes we need to know if you require us to refurbish the existing lanterns or replace the lanterns with the standard type.

Although the lanterns and columns are currently decorative they are not covered on the designated lists, so under the contract we would replace with standard. All columns are DTC (deemed to comply) so we can refurbish the lanterns only if you wish, however funding will be required to cover the additional costs.

There are also two columns which have previously been knocked down and are currently standard units. If you would like these to be replaced with matching decorative units funding will be required to cover the uplift costs.

You have 21 working days to look at these plans and provide feedback to Balfour Beatty, by 1 December 2015.

If you have any questions do not hesitate to contact me.

Kind regards

Natasha Dillon

Client Liaison | Balfour Beatty | Services | Living Places

T: +44 (0) 1954 233300 M: +44 (0)7811976550 | E: natasha.dillon@bblivingplaces.com
Buckingway Business Park, Anderson Road, Swavesey, Cambs, CB24 4UQ.

Balfour Beatty

Build to Last
Lean. Expert. Trusted. Safe.

This email may contain information which is confidential and is intended only for use of the recipient/s named above. If you are not an intended recipient, you are hereby notified that any copying, distribution, disclosure, reliance upon or other use of the contents of this email is strictly prohibited. If you have received this email in error, please notify the sender and destroy it.

Balfour Beatty Utility Solutions Limited, registered in England and Wales: Company No.1062438.

Registered Office: Park Square, Newton Chambers Road, Thorncliffe Park, Chapeltown, Sheffield, S35 2PH, as agent of Balfour Beatty Group Limited, registered no. 101073, registered office 130 Wilton Road, London, SW1V 1LQ

Warning: Although the company has taken reasonable precautions to ensure no viruses or other malware are present in this email, the company cannot accept responsibility for any loss or damage arising from the use of this email or attachments.

This email has been scanned by the Symantec Email Security.cloud service.

For more information please visit <http://www.symanteccloud.com>

Key

- Refurbish Lantern Only
Philipa Mini Midium GC5451 - FT
10 Degrees
Control: 15
- Lamp: 60W GPC-TW
Tolensa (Dali Xtreme Ballast)
- Refurbish Lantern Only
Philipa Mini Midium GC5235 - FT
10 Degrees
Control: 15
- Lamp: 100W SCN-T
Tolensa (Dali Xtreme Ballast)
- Existing Illuminated Object to be Removed to Top of Site
- Solar Powered Ballast
Keep Left
- Existing LA Cable to be Disconnected and Abandoned

Design Notes

1. 1-4-LIME-6c (Residential) Lighting Design
2. All work to be completed in accordance with the relevant standards and subject to approval upon installation.
3. On site hazards/issues include:
HV Underground Cables
4. All traffic signs to be replaced with new signs.
Lamp posts are not covered on designated list.
5. BB propose to either:
- Refurbish existing lanterns (please note that additional maintenance fees will be payable)
- Install standard Midium Lanterns onto existing columns
- Columns CC24L38 & CC41L10 has been replaced due to breakdown. Decorative columns & lanterns to match existing style can be installed if approved and funded by CCC or
6. Lighting calculation: Trial calculation has been prepared to demonstrate achieved lighting levels.

Spacing Calculation

Road Category: 1
Road Width (m): Max 24m
Shouldered: Single
Staggered: 35m

Notes

- 1. RESIDENTIAL DIM TO 60% BETWEEN 22.00 & 00.00
- WARNING - THERE ARE BURIED SERVICES WITHIN THIS SCHEME. ALL WORK SHOULD BE STOPPED IMMEDIATELY IF ANY UNIDENTIFIED SERVICES ARE ENCOUNTERED. THE CONTRACTOR SHOULD VERIFY THE LOCATION AND DEPTH OF ALL SERVICES PRIOR TO INSTALLATION AND ENSURE DIG PACK CONTAINS ALL THE INFORMATION.
- DISCLAIMER: THE CONTRACTOR SHALL BE RESPONSIBLE FOR OBTAINING ALL NECESSARY PERMISSIONS FROM THE LOCAL AUTHORITY PRIOR TO COMMENCING WORK. THE CONTRACTOR SHALL BE RESPONSIBLE FOR OBTAINING ALL NECESSARY PERMISSIONS FROM THE LOCAL AUTHORITY PRIOR TO COMMENCING WORK. THE CONTRACTOR SHALL BE RESPONSIBLE FOR OBTAINING ALL NECESSARY PERMISSIONS FROM THE LOCAL AUTHORITY PRIOR TO COMMENCING WORK.

streetlighting

Designer	AW	Date of Issue	5/1/15
Checked	SM	Sheet Size	A2
Authorised	NB	Scale	1:500 @ A2
Status	PRELIMINARY	Revision	ORIG.
Drawing no.	7200-1031-V1		

Scheme Name and Ward:
1031, Cambourne
Schemes on drawing:
School Lane, Sheet 1 of 3
ID: 699

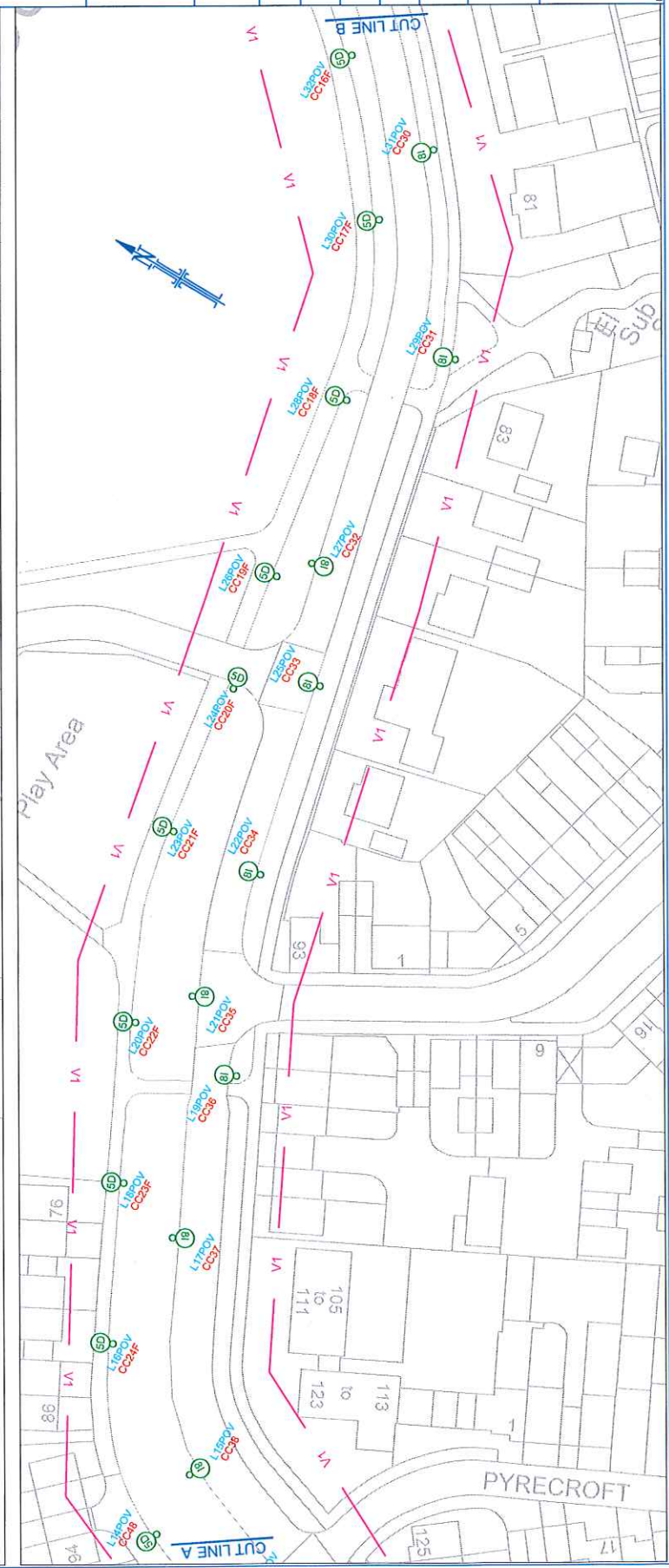
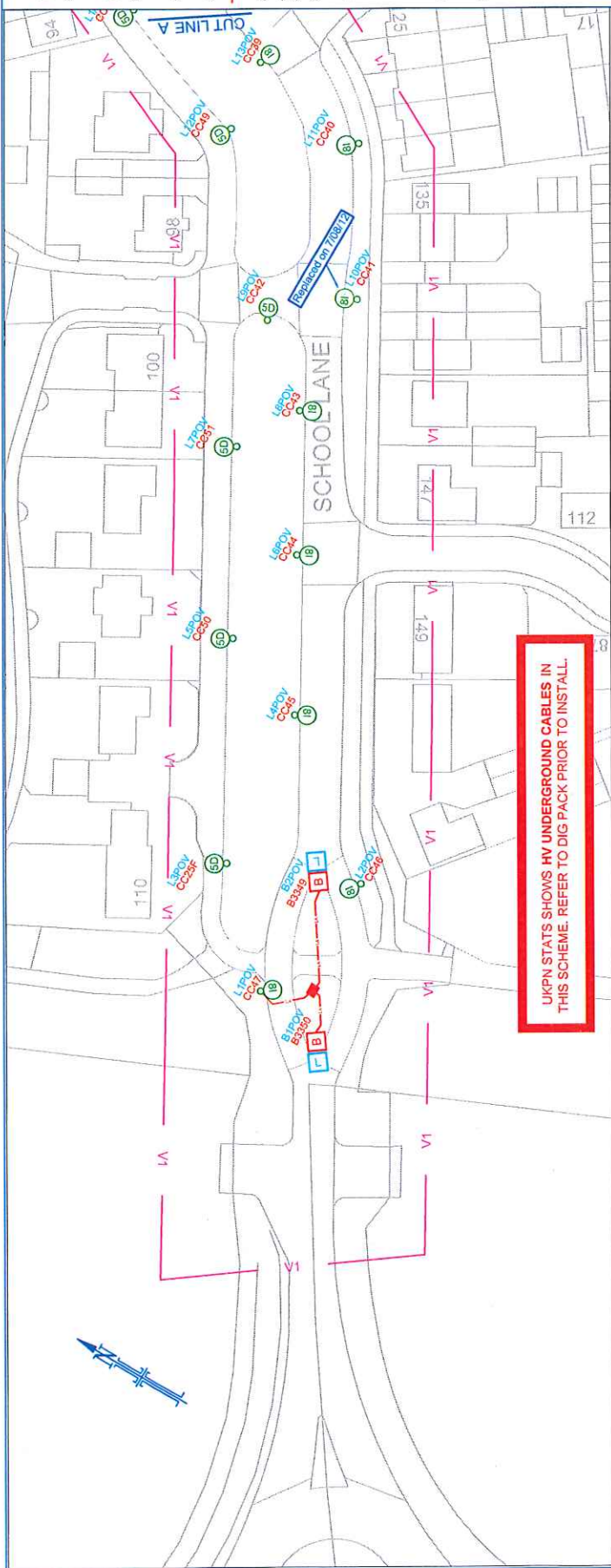

Key

- Lantern:** Refurbish Lantern Only
- Column:** Philips Mini Iridium SC2451 - PT
- Control:** 10 Degree
- Quantity:** 78 Remain
- Lantern:** Refurbish Lantern Only
- Column:** Philips Mini Iridium SC2451 - PT
- Control:** 10 Degree
- Quantity:** 100W SCS-T
- Lamp:** Telera (Dali Xtreme Ballast)
- Control:** Telera (Dali Xtreme Ballast)

- Solar Powered Bollard:** Keep Left
- Fact:** Existing LV Cable to be Disconnected and Abandoned

Design Notes

- 1-4-TIME-6 (Residential) Lighting Design
- All column locations on drawing and markings on site are to be replaced with new columns upon installation.
- On site hazardous cables include:
 - HV Underground Cables
 - Live traffic
 - Lanterns are not covered on designated list.
- BB propose to either:
 - Refurbish existing lanterns (please note that additional maintenance fees will be payable)
 - Install standard Iridium Lanterns onto existing columns
- Columns CC24/L39 & CC41/L10 has been replaced due to knockdown. Decorative columns & lanterns to match existing style can be installed if approved and funded by CCC or Parish
- Lighting calculation. Trial calculation has been prepared to demonstrate achieved lighting levels.

Spacing Calculation

Road Calculation 1	Max
Spacing (m)	24m
Spaced	35m
Suggested	

Notes

- DIMMING REGIME**
- RESIDENTIAL DM TO 60% BETWEEN 22.00 & 06.00**
- WARNING - THERE ARE BURIED SERVICES WITHIN THIS SCHEME. REFER TO DIG PACK PRIOR TO REMOVAL / INFORMATION. ENSURE DIG PACK CONTAINS ALL THE INFORMATION.**



Designer	AW	Date of Issue	5/1/15
Checked	SM	Authorised	NB
Issue	PRELIMINARY	Sheet Size	A2
Revision	ORIG.	Scale	1:500 @ A2

Drawing no. 7200-1031-V1

Scheme Name and Ward: 1031, Cambourne

Sheets on drawing: School Lane, Sheet 2 of 3

ID: 699

(C) Crown copyright and database rights 2015 Ordnance Survey 100023205.

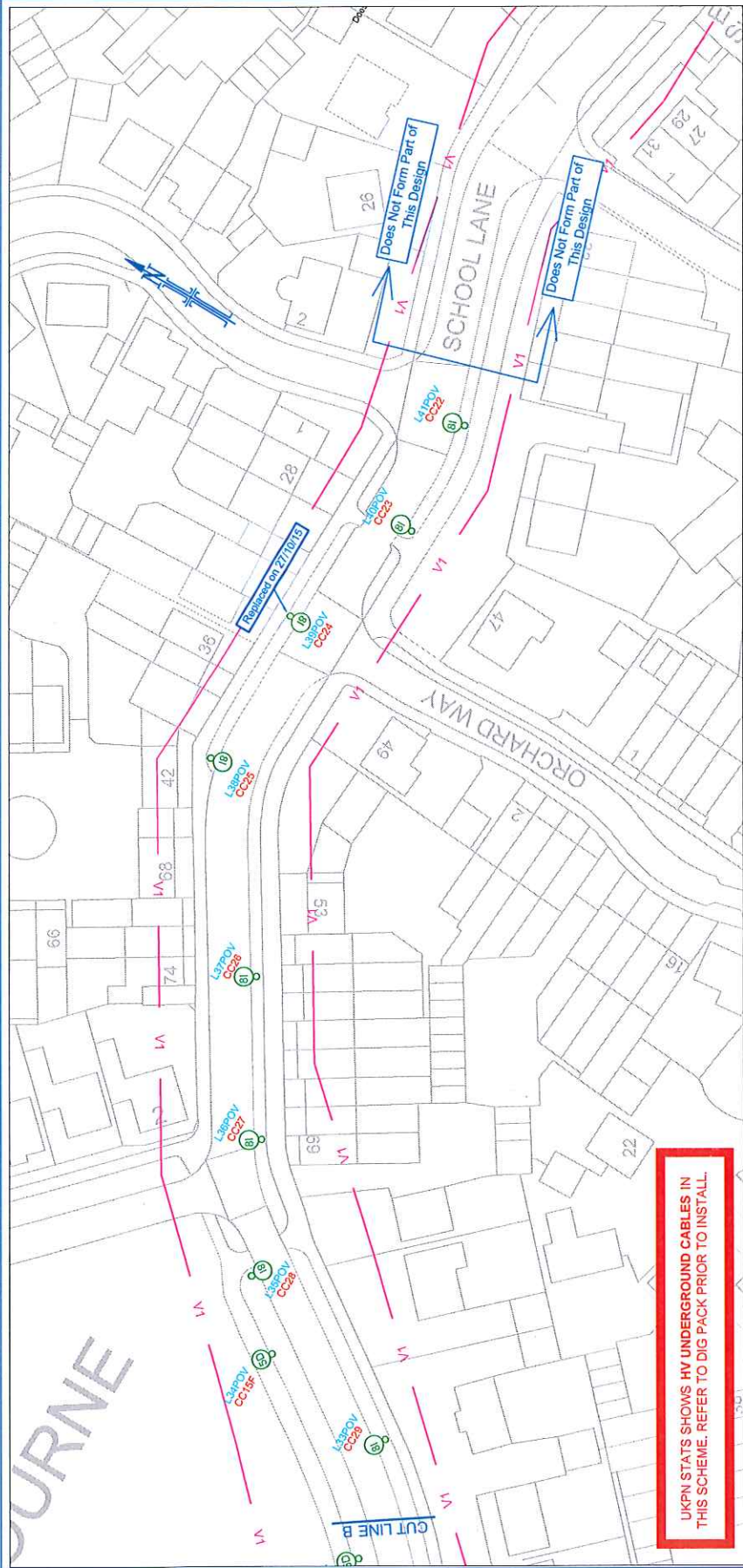

UKPN STATS SHOWS HV UNDERGROUND CABLES IN THIS SCHEME. REFER TO DIG PACK PRIOR TO INSTALL.

Lanterns are not covered on designated list.
BB propose to either:
- Refurbish existing lanterns (please note that additional maintenance fees will be payable)
- Install standard Iridium Lanterns onto existing columns

Columns CC24/L39 and CC41/L10 are currently standard units. (Replaced due to knockdown)
Decorative columns & lanterns to match existing style can be installed if approved and funded by CCC or Parish

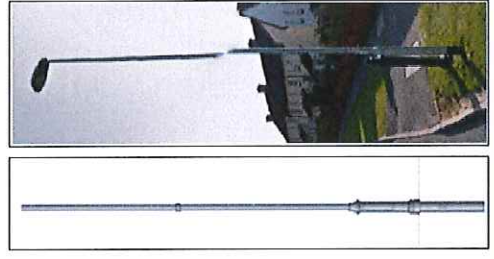
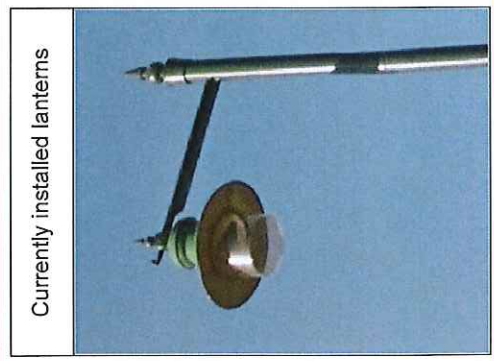
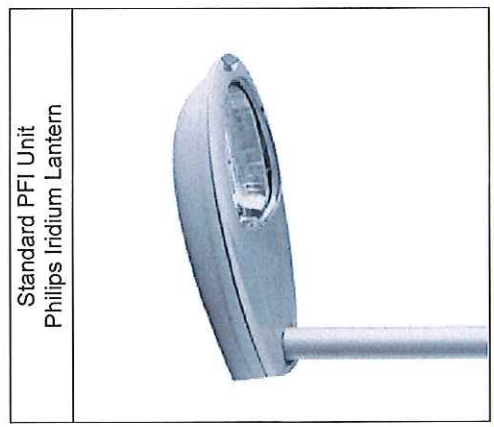

Currently installed lanterns

Standard PFI Unit
Philips Iridium Lantern

AGENDA ITEM No. 13

John Vickery

From: Jakes Ben <Ben.Jakes@cambridgeshire.gov.uk>
Sent: 25 November 2015 10:44
To: 'Simon Crocker'
Cc: 'John Vickery'; Loynes Mervyn Cllr; Criswell Steve Cllr; Blackburne-Maze Tom
Subject: Cambourne street lights

Dear Cllr Crocker,

I have been asked to look into your comments regarding the 41 units on School Lane due for upgrade under our Core Investment Programme. Having spoken with Balfour Beatty, we have resolved your concerns with regard to the replacement of the lanterns with standard lanterns as per the contract, Balfour Beatty will now refurbish the present bespoke lanterns with no additional funding required from the Parish Council. I shall ask Balfour Beatty to re-issue the designs with this in mind.

Also, as I understand it, two of the three temporary columns have been replaced, with the third columns to be programmed to be replaced next week.

Trusting the above is in order.

Thank you

Ben Jakes
Commission Officer
Assets and Commissioning
Cambridgeshire County Council
Omega House
Anderson Road, Buckingway Business Park
Swavesey
Cambridge
CB24 4UQ
01954233305
07780005965

From: Blackburne-Maze Tom
Sent: 19 November 2015 09:26
To: 'Simon Crocker'
Cc: 'John Vickery'; Loynes Mervyn Cllr
Subject: RE: Cambourne street lights

Dear Councillor,

Thank you. I have asked an officer from my service to contact you next week to discuss this matter further with you.

Regards

Tom

Tom Blackburne-Maze
Head of Assets and Commissioning
Economy, Transport and Environment
Cambridgeshire County Council, SH1313, Shire Hall, Castle Hill, Cambridge, CB3 0AP
Tel: 01223 699772
Mob: 07795 092958

From: Simon Crocker [<mailto:cllr.crocker@cambourneparishcouncil.gov.uk>]
Sent: 18 November 2015 14:48
To: Blackburne-Maze Tom
Cc: John Vickery
Subject: Re: Cambourne street lights

Hi Tom.

I have a prior appointment at South Cambs District Council at that time on Friday, but could meet from 11:30 onward, or failing that, during the day on any day the following week.

Regards

Simon Crocker

Chairman- Cambourne Parish Council
District Councillor – Bourn Ward

From: [Blackburne-Maze Tom](#)
Sent: Monday, November 16, 2015 3:01 PM
To: [Loynes Mervyn Cllr](#)
Cc: [Simon Crocker](#)
Subject: RE: Cambourne street lights

Dear Councillor,

I have rearranged my diary to make a slot and can come to Cambourne for 10.30 on Friday if that is convenient for you.

Regards

Tom

Tom Blackburne-Maze
Head of Assets and Commissioning
Economy, Transport and Environment
Cambridgeshire County Council, SH1313, Shire Hall, Castle Hill, Cambridge, CB3 0AP
Tel: 01223 699772
Mob: 07795 092958

-----Original Message-----

From: Mervynloynes [<mailto:mervynloynes@btinternet.com>]
Sent: 16 November 2015 09:14
To: Blackburne-Maze Tom
Cc: Simon Crocker
Subject: Cambourne street lights

Good morning Tom, Cambourne PC We're contacted by Balfour Beatty ,to say they were going to start working on the street lights in School Lane,Cambourne, the Parish Council do not want the street lights altered in any way. I would like you to come to Cambourne this Thursday or Friday to the Parish Council office to meet with. Simon Crocker the PC Chairman , myself and John Vickery the PC clerk to discuss the street lamps of Cambourne. Please give me a time that is convenient, many thanks.
Cambridgeshire County Councillor

South Cambridgeshire District Councillor Mervyn Loynes

Sent from my iPad

The information in this email is confidential and may be legally privileged. It is intended solely for the addressee. If you receive this email by mistake please notify the sender and delete it immediately.

Opinions expressed are those of the individual and do not necessarily represent the opinion of Cambridgeshire County Council. All sent and received email from Cambridgeshire County Council is automatically scanned for the presence of computer viruses and security issues. Visit

www.cambridgeshire.gov.uk<<http://www.cambridgeshire.gov.uk>>

The information in this email is confidential and may be legally privileged. It is intended solely for the addressee. If you receive this email by mistake please notify the sender and delete it immediately. Opinions expressed are those of the individual and do not necessarily represent the opinion of Cambridgeshire County Council. All sent and received email from Cambridgeshire County Council is automatically scanned for the presence of computer viruses and security issues. Visit www.cambridgeshire.gov.uk

AGENDA ITEM No. 13

Commuted Sum Calculation

Start Year 2015

Num Cols 41

ENERGY

Pence per kWh	
Energy Inflation	
Burning Hours	
Actual Wattage	

MAINTENANCE

Base Price	£ 8.62
Inflation	2.5%

Num	Year	Energy Cost	kWh	£	Year	Cost	Num Years	Energy	Maint	Qty	Total
1	2015	0.00p	0	£ -	2015	£ 8.62	25	£ -	£ 294.44	41	£ 12,072.04
2	2016	0.00p	0	£ -	2016	£ 8.84	30	£ -	£ 378.44	41	£ 15,516.09
3	2017	0.00p	0	£ -	2017	£ 9.06	35	£ -	£ 473.48	41	£ 19,412.73
4	2018	0.00p	0	£ -	2018	£ 9.28	40	£ -	£ 581.01	41	£ 23,821.41
5	2019	0.00p	0	£ -	2019	£ 9.51					
6	2020	0.00p	0	£ -	2020	£ 9.75					
7	2021	0.00p	0	£ -	2021	£ 10.00					
8	2022	0.00p	0	£ -	2022	£ 10.25					
9	2023	0.00p	0	£ -	2023	£ 10.50					
10	2024	0.00p	0	£ -	2024	£ 10.77					
11	2025	0.00p	0	£ -	2025	£ 11.03					
12	2026	0.00p	0	£ -	2026	£ 11.31					
13	2027	0.00p	0	£ -	2027	£ 11.59					
14	2028	0.00p	0	£ -	2028	£ 11.88					
15	2029	0.00p	0	£ -	2029	£ 12.18					
16	2030	0.00p	0	£ -	2030	£ 12.48					
17	2031	0.00p	0	£ -	2031	£ 12.80					
18	2032	0.00p	0	£ -	2032	£ 13.12					
19	2033	0.00p	0	£ -	2033	£ 13.44					
20	2034	0.00p	0	£ -	2034	£ 13.78					
21	2035	0.00p	0	£ -	2035	£ 14.12					
22	2036	0.00p	0	£ -	2036	£ 14.48					
23	2037	0.00p	0	£ -	2037	£ 14.84					
24	2038	0.00p	0	£ -	2038	£ 15.21					
25	2039	0.00p	0	£ -	2039	£ 15.59					
26	2040	0.00p	0	£ -	2040	£ 15.98					
27	2041	0.00p	0	£ -	2041	£ 16.38					
28	2042	0.00p	0	£ -	2042	£ 16.79					
29	2043	0.00p	0	£ -	2043	£ 17.21					
30	2044	0.00p	0	£ -	2044	£ 17.64					
31	2045	0.00p	0	£ -	2045	£ 18.08					
32	2046	0.00p	0	£ -	2046	£ 18.53					
33	2047	0.00p	0	£ -	2047	£ 19.00					
34	2048	0.00p	0	£ -	2048	£ 19.47					
35	2049	0.00p	0	£ -	2049	£ 19.96					
36	2050	0.00p	0	£ -	2050	£ 20.46					
37	2051	0.00p	0	£ -	2051	£ 20.97					
38	2052	0.00p	0	£ -	2052	£ 21.49					
39	2053	0.00p	0	£ -	2053	£ 22.03					
40	2054	0.00p	0	£ -	2054	£ 22.58					