

## John Vickery

---

**From:** David Fletcher <david.fletcher@rpsgroup.com>  
**Sent:** 30 September 2014 16:26  
**To:** Edward.Durrant@scambs.gov.uk; Blower Linda;  
clerk@cambourneparishcouncil.gov.uk  
**Cc:** Martyn Rodzian - TW East Anglia; Nicholas Roberts (Oxford Transport)  
**Subject:** Cambourne Welcome Packs and Website  
**Attachments:** JNY7589-01A Draft Travel Information Pack.pdf

Dear All

We have now finalised the Welcome Pack (attached) and website [www.cambournetravelplan.com](http://www.cambournetravelplan.com). If you are able to take a look at them and provide us with any comments or anything you think would be beneficial including in them then we will endeavour to take your comments on board.

South Cambs thank you for providing your feedback on the Travel Survey. If Cambridgeshire or Cambourne Parish Council have any comments on the Travel Survey I sent through on 12/09/14 then please get in contact as soon as possible as we are looking to undertake the surveys in the coming weeks.

Many thanks

---

**David Fletcher BA (Hons) MSc MCIHT MILT**  
**Senior Consultant - RPS Planning & Development**  
20 Western Avenue, Milton Park,  
Abingdon, Oxfordshire, OX14 4SH.  
United Kingdom  
**Tel:** +44 (0) 1235 432 190  
**Fax:** +44 (0) 1235 834 698  
**Email:** [david.fletcher@rpsgroup.com](mailto:david.fletcher@rpsgroup.com)  
**www:** [www.rpsgroup.com](http://www.rpsgroup.com)

---

This e-mail message and any attached file is the property of the sender and is sent in confidence to the addressee only.

Internet communications are not secure and RPS is not responsible for their abuse by third parties, any alteration or corruption in transmission or for any loss or damage caused by a virus or by any other means.

RPS Planning and Development Limited, company number: 02947164 (England). Registered office: 20 Western Avenue Milton Park Abingdon Oxfordshire OX14 4SH.

RPS Group Plc web link: <http://www.rpsgroup.com>



# UPPER CAMBOURNE

# TRAVEL INFORMATION

# PACK



## INTRODUCTION

Welcome to your new home. As you settle in to a new location, we would like to assist you to make the move as easy as possible. This Travel Information Pack sets out the different transport options that are available to residents of Upper Cambourne and provides information to assist you in making sustainable choices about the way in which you travel. Cambourne has been designed so that nearly all journeys can be undertaken within the town and these journeys can be made by sustainable modes, including by foot.

This Pack contains:

- Walking and cycling information
- Rail information and route maps
- Bus information and route maps
- Advice on saving money on car travel
- Details on obtaining your free personal travel plan

Up to date travel information is available on the Cambourne Travel Information Website which can be found at the address below:

[www.cambournetravelplan.com](http://www.cambournetravelplan.com)

To assist with travel choices, Upper Cambourne has a Travel Plan Coordinator who implements and manages the Travel Plan. If you have any further travel queries please contact David Fletcher using the below details.

The TP Coordinator can be contacted on:

**Contact:** David Fletcher  
**Tel:** 01235 432 190  
**Email:** [david.fletcher@rpsgroup.com](mailto:david.fletcher@rpsgroup.com)

The Travel Information Pack has been produced as part of a Travel Plan which has been prepared for Upper Cambourne. The main objectives of the plan are to reduce the level of trips in Upper Cambourne by car.

We are not responsible for the content of external websites or the actions of any companies listed within this Information Pack.

## WALKING AND CYCLING

Walking is one of the simplest, easiest, and cheapest ways to get around. This is particularly true at Cambourne whereby good quality, direct and well lit pedestrian routes are provided throughout Cambourne connecting the site to public transport stops, local shopping areas, leisure and education facilities. It is also easy to cycle around Cambourne via signed on and off road routes.

### Benefits of walking and cycling include:

**Being Healthy** – walking burns 100 calories in 20 minutes and can help reduce weight

**Saving Money** – no fuel or parking costs

**Being Green** – reduce your environmental impact

**Enjoyable** - activity is good for physical and mental health



Walking or cycling can often be combined with other modes of transport for part of the journey, e.g. bus or train. The existing network of pedestrian and cycle routes within Cambourne around the Upper Cambourne site is shown in **Map 1** which demonstrates the extensive pedestrian and cycle routes. The existing residential areas are designed to be easily reached by foot via direct walking routes. For cyclists there are a mixture of on and off-road direct routes.

Pedestrian and cycle routes have also been extended out into the countryside. Cyclists can also use the old A428 to access Cambridge, with on carriageway cycle lanes provided on part of the route. The A428 provides a suitable cycle route as it is relatively flat and straight.

**Map 2** illustrates the location of community facilities and amenities in relation to the site and shows that there is a wide range of facilities and amenities within a 5, 10, 15, 20 and 25 minute walking distance of the site. The extensive pedestrian network allows access to a number of facilities within appropriate walking distances.

Map 1 – Walking and Cycling Routes around Cambourne

- KEY
- Extent of development
  - Routes
    - Pedestrian
    - Cycle
    - Bride path

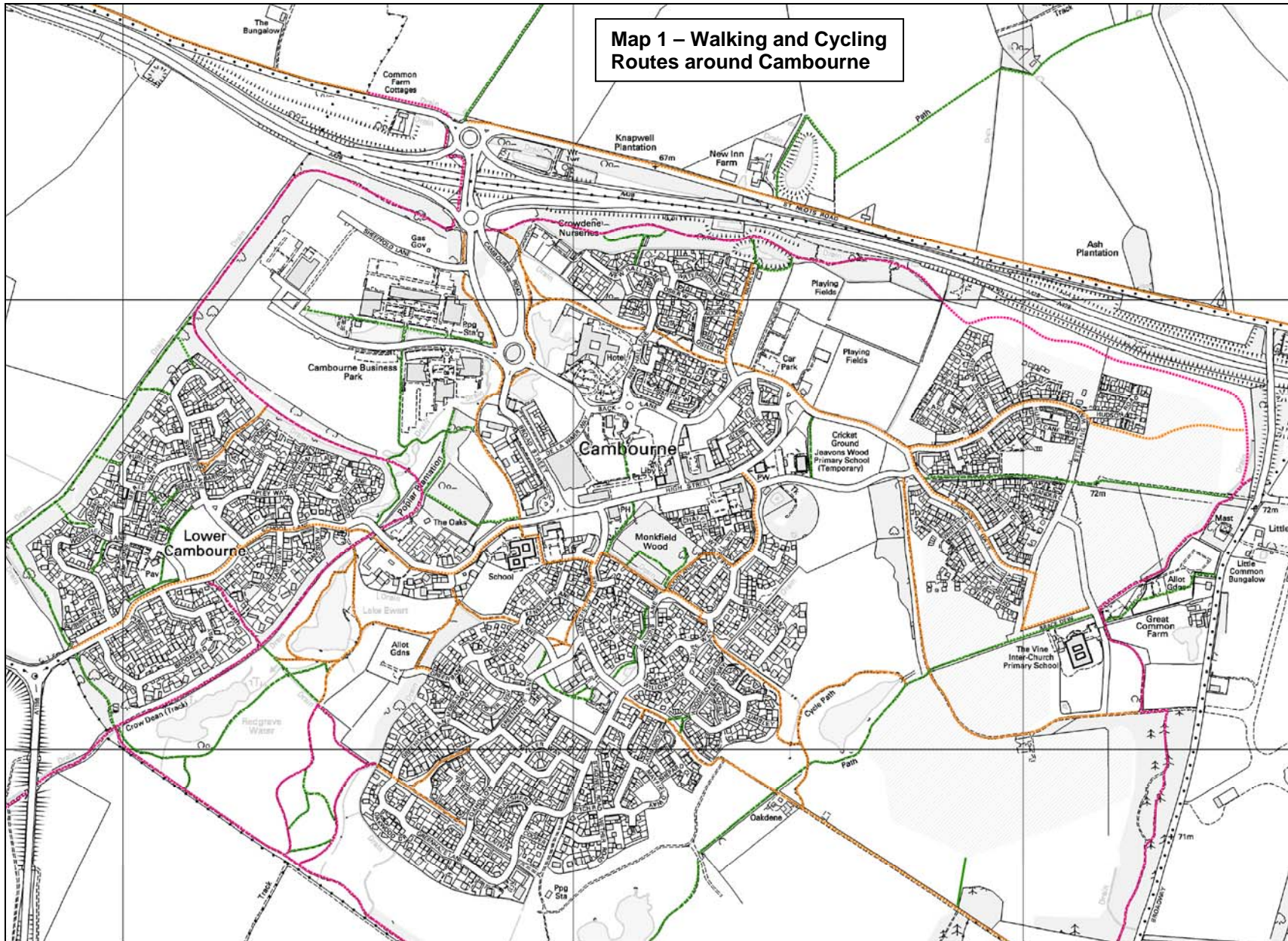

Map 2 – Facilities and Amenities within Cambourne

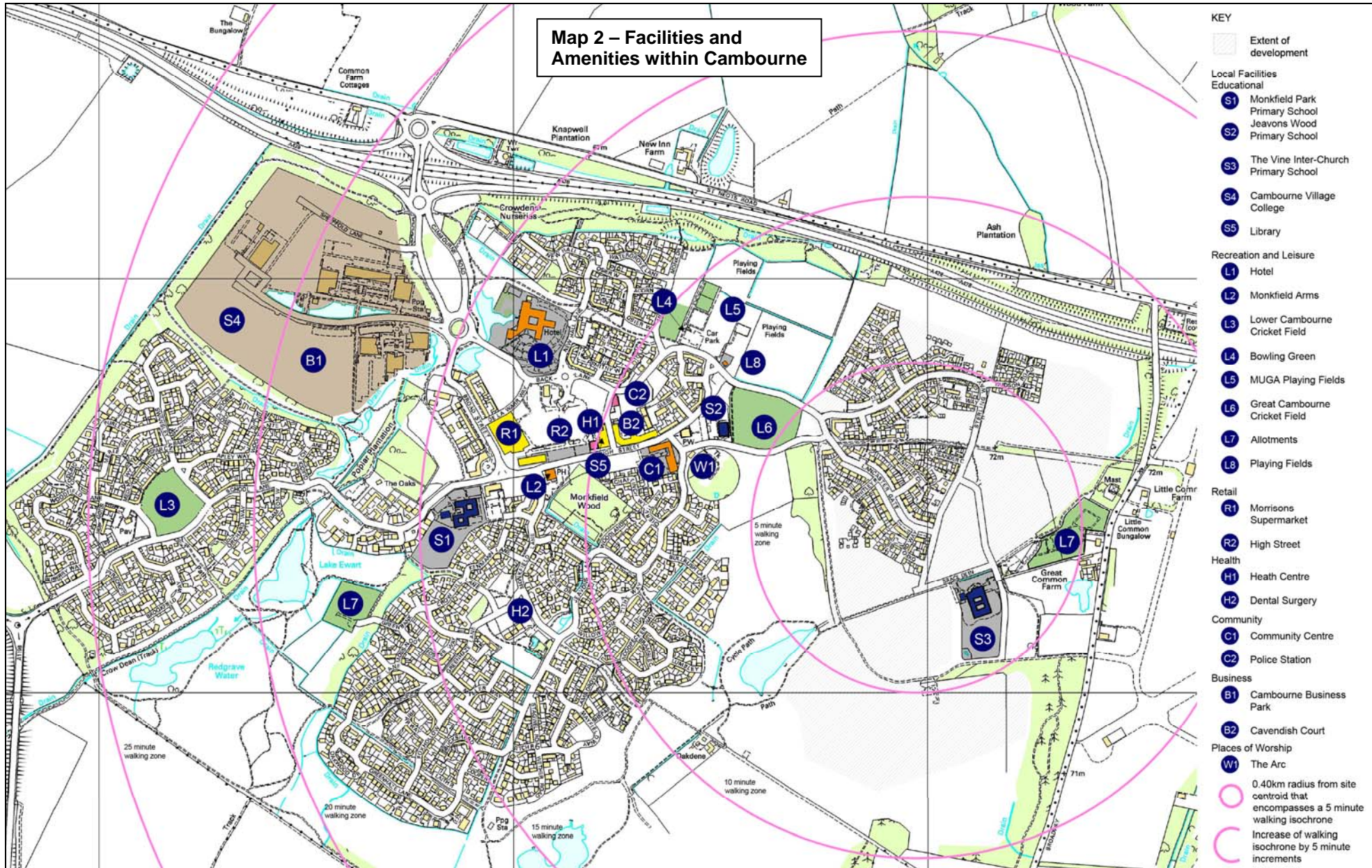

**Walkbudi:**

<https://walkbudi.liftshare.com>

WalkBUDI matches you up with other people who want to go the same way as you - so you can walk together. It's as easy as that – and totally free to use. You just need to register your journey and then do a search for others in your area wanting to share their walk. It makes walking fun, safer and more sociable.

**Cycle Parking**

The location of cycle parking within Cambourne around the high street is shown within the below map as obtained from:

<http://cambridge.cyclestreets.net/journey/to/52.22194,-0.07359/Cambourne/>

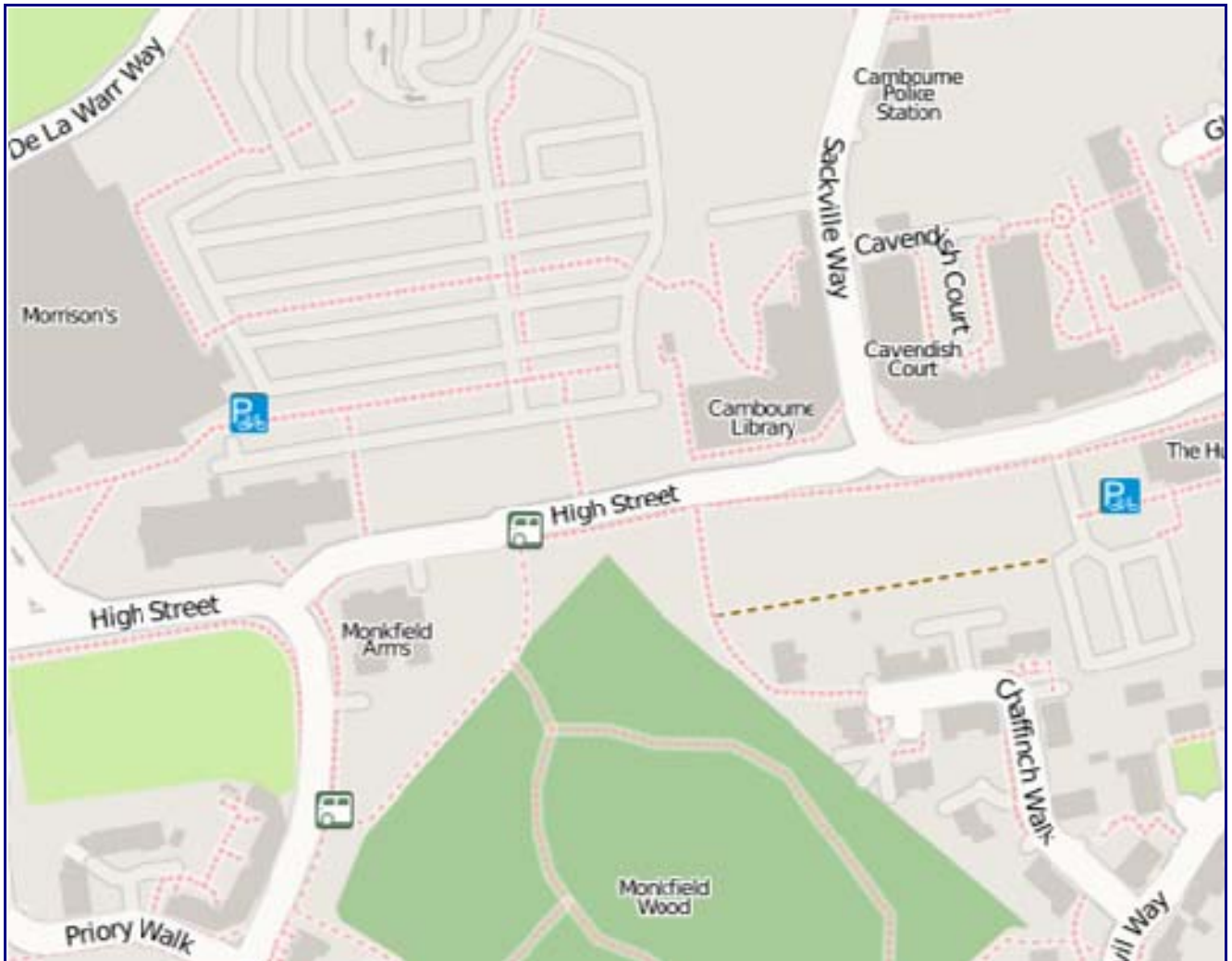
**Cycle Route Planning**

To plan your cycle route from Cambourne visit Cambridge CycleStreets. CycleStreets is a UK-wide cycle journey planner system, which lets you plan routes from A to B by bike. It is designed by cyclists, for cyclists, and caters for the needs of both confident and less confident cyclists.

<http://cambridge.cyclestreets.net/journey/to/52.22194,-0.07359/Cambourne/>



**Bikebudi**

<https://bikebudi.liftshare.com>

If you want some company on your bike ride (whether that's to work or just for fun), the system matches you up with others going the same route, so you can ride together.



It doesn't matter whether you're an experienced cyclist who'd just like the company, or a beginner who'd feel happier not riding alone – BikeBUDI is for everyone.

**Local Cycle Shop**

[www.richardsonsonline.co.uk](http://www.richardsonsonline.co.uk)

<p>Richardsons Cycles 185-189 Newmarket Road Cambridge Cambridgeshire CB5 8HA Tel: 01223 322450 <a href="mailto:cambridge@richardsonsonline.co.uk">cambridge@richardsonsonline.co.uk</a></p>	<p>Richardsons Cycles 51 Ermine Street, Huntingdon Cambridgeshire PE29 3EZ Tel: 01480 453492 <a href="mailto:huntingdon@richardsonsonline.co.uk">huntingdon@richardsonsonline.co.uk</a></p>	<p>Richardsons Cycles 7 The Broadway St Ives Cambridgeshire PE27 5BX Tel: 01480 463127 <a href="mailto:stives@richardsonsonline.co.uk">stives@richardsonsonline.co.uk</a></p>
----------------------------------------------------------------------------------------------------------------------------------------------------------------------------------------------------------------------	---------------------------------------------------------------------------------------------------------------------------------------------------------------------------------------------------------------------	-------------------------------------------------------------------------------------------------------------------------------------------------------------------------------------------------------

**Safer Cycling Scheme – Cambridgeshire County Council**

[www.cambridgeshire.gov.uk/info/20020/cycling/127/cycle\\_safety](http://www.cambridgeshire.gov.uk/info/20020/cycling/127/cycle_safety)

This provides information on safe courses for children and on links for adult cycle training.

**Cycle Training****Bikeability**

[www.dft.gov.uk/bikeability/the-three-levels/cycling-skills-for-adults/](http://www.dft.gov.uk/bikeability/the-three-levels/cycling-skills-for-adults/)

This provides links to cycle instruction for adults to build confidence if you have recently rediscovered your enthusiasm for cycling.

One company which offers training throughout Cambridgeshire are Riding a Bike:

[www.ridingabike.co.uk](http://www.ridingabike.co.uk)





## PUBLIC TRANSPORT



Public Transport can be more convenient, quicker, and cheaper than travelling via car and provides environmental benefits too. Car journeys contribute a significant amount towards our overall carbon footprint. Public Transport allows you to reach a central point such as Cambridge directly rather than getting on a one-way system or diverting via a car park. You also get the benefit of relaxing with a newspaper or using a portable media device. Public transport can also be quicker, especially as more investment is made into the public transport network. If you regularly travel the same journey or planning in advance you can make cost savings as the cost of running a car is more than just the cost of petrol. Public transport means no car insurance, tax, MOT or car maintenance. Finally public transport does not require looking for a parking space upon arrival at your destination or the expensive cost of parking.

Details of public transport services which can be accessed from the site are set out below.

### **Bus Services**

There are a number of buses that stop close to the site. Local bus stops are shown on the map below. The bus stop map has been extracted from the [www.cambridgeshirebus.info](http://www.cambridgeshirebus.info) site which can also be used to access real-time bus information from each stop.

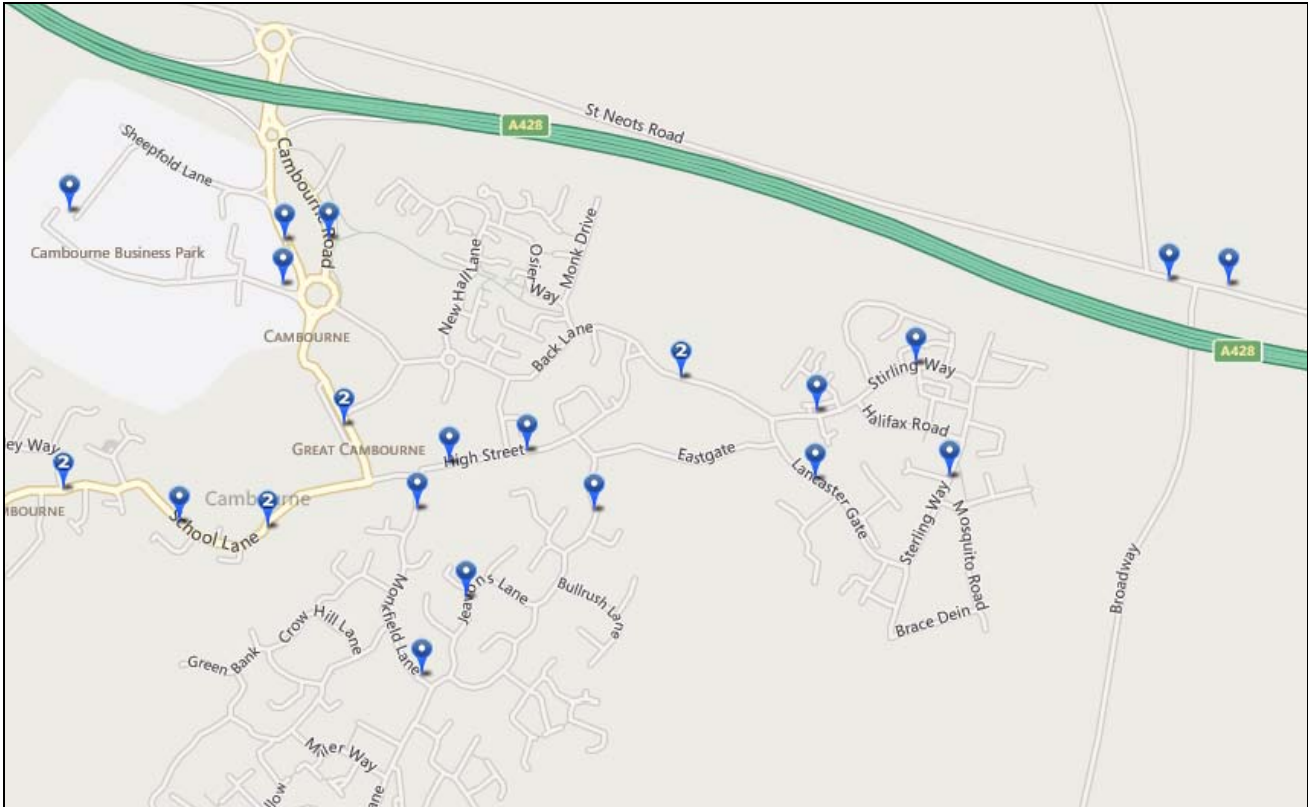

The routes of the Citi4 bus is shown below. Timetables can be found at the below site:  
[www.cambridgeshire.gov.uk/site/custom\\_scripts/bus\\_timetable\\_by\\_location.aspx?Loc=Cambourne](http://www.cambridgeshire.gov.uk/site/custom_scripts/bus_timetable_by_location.aspx?Loc=Cambourne)

A summary of the services within the vicinity of the site is shown below.

**Bus Services within the vicinity of the site**

Service	Stops	Provider	Description	Frequency
1	Cambourne	Whippet Coaches Ltd	<b><u>Papworth Everard - St Ives - Cambridge</u></b> Runs Monday to Saturday	Approx Hourly from 0730-1830
2	St Neots Road	Whippet Coaches Ltd	<b><u>Cambridge - Hardwick - Toft - Caldecote - Boxworth</u></b> Runs Monday to Friday	1 service in each direction per day
Citi 4	Cambourne	Stagecoach	<b><u>Cambridge - Hardwick - Cambourne</u></b> Runs Every day	Approx every 20 mins Mon-Sat from 0720-2320. Hourly on a Sunday
18	Cambourne	Stagecoach	<b><u>Cambridge - Comberton - Cambourne - Eltisley (- Gamlingay)</u></b> Runs Monday to Saturday	Approximately hourly from 0840-1930
28	Cambourne	Whippet Coaches Ltd	<b><u>St Neots - Abbotsley - Gamlingay - Cambourne (- Papworth)</u></b> Runs Monday to Saturday	2-3 services per day in each direction from 0930-1430

The routes of the Citi4 bus service is shown overleaf.

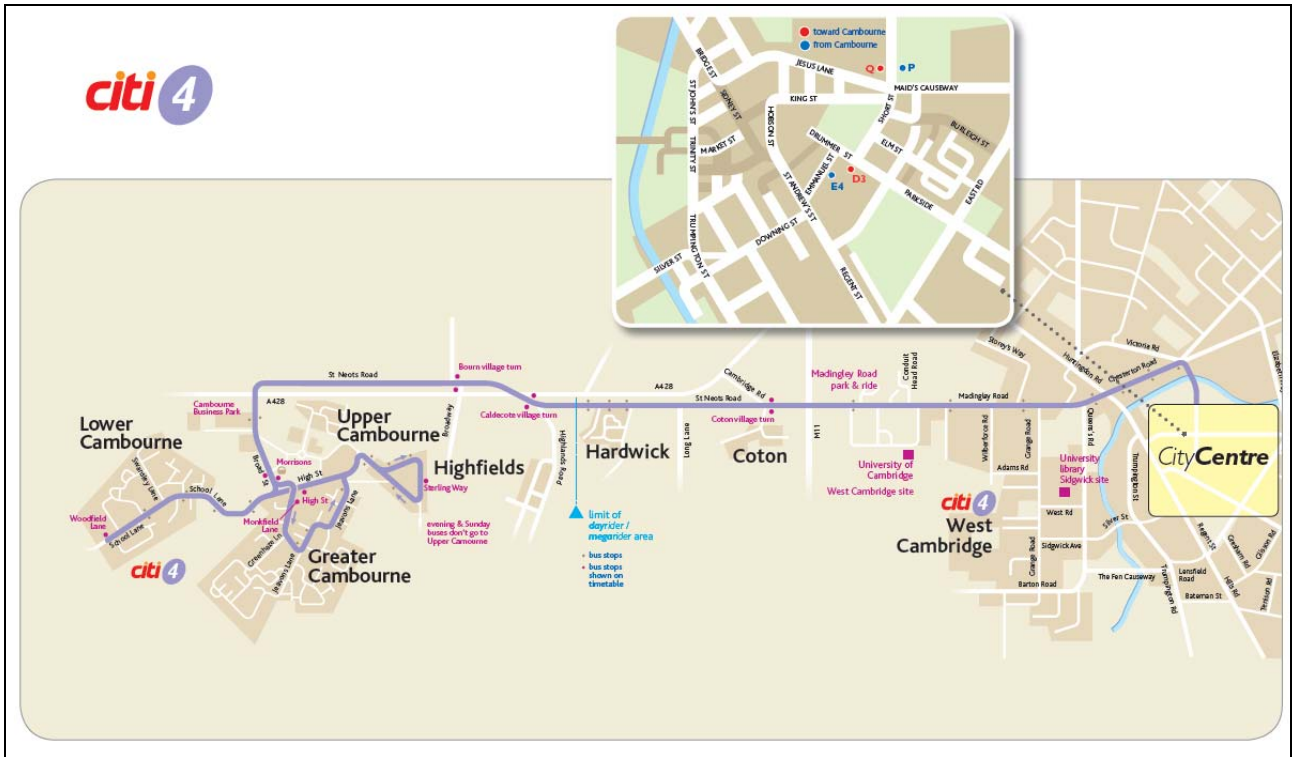

The routes of all bus services within Camboorne are shown in the Map overleaf.

Map 3 – Bus Services within Cambourne

KEY

- Extent of development
- Bus Services - by number
  - 1
  - CITI 4
  - 18
  - 2
  - Bus stop

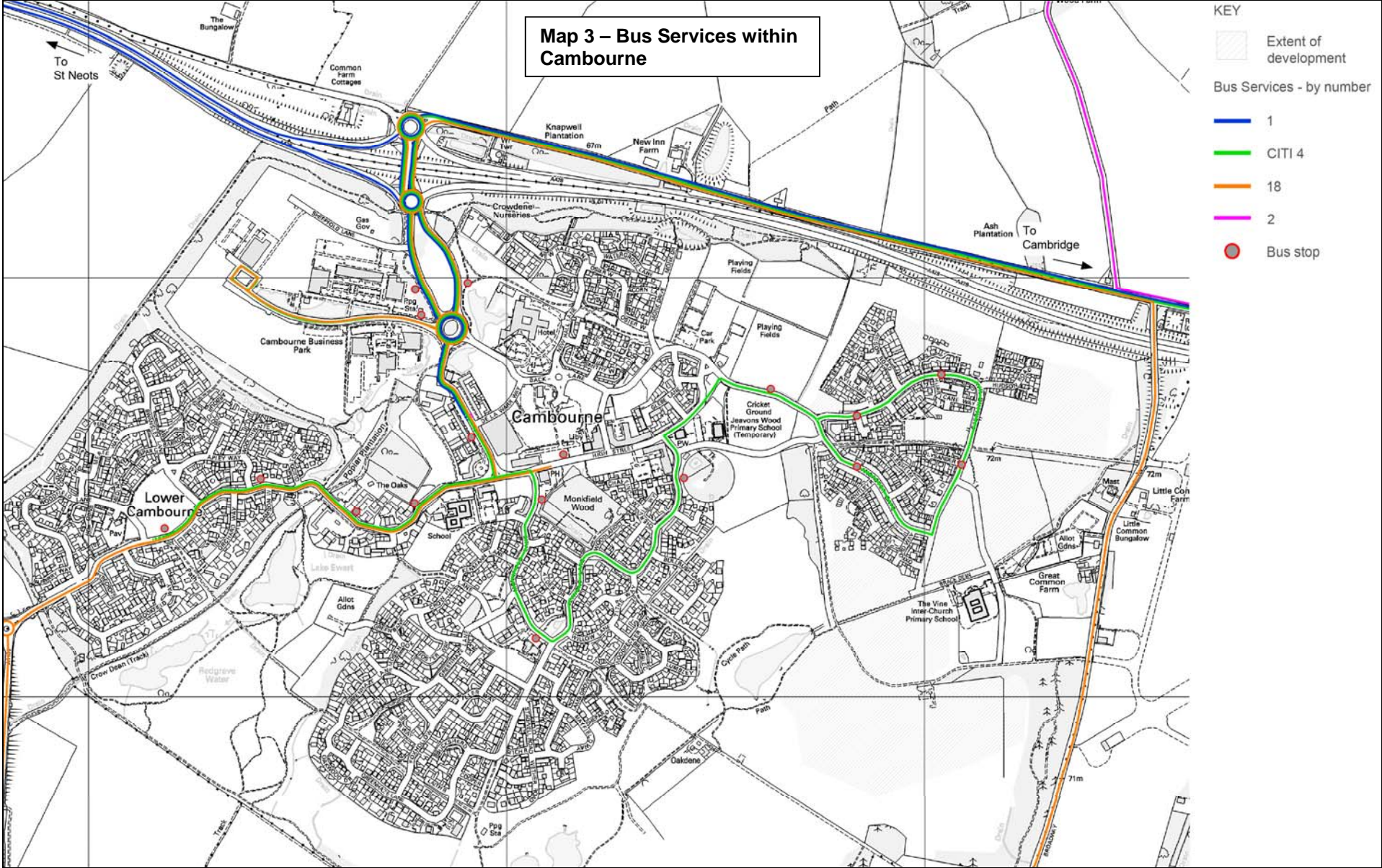

**Rail Services**

In terms of rail, services operating out of both St Neots and Cambridge railway stations enable direct and frequent services to London, Birmingham, Ipswich, Kings Lynn, Peterborough and Stansted. Cambridge Railway Station is approximately a 45 minute bus journey from Cambourne and St Neots is approximately a 70 minute bus journey from the site.

The Table below shows the destinations, peak frequencies and journey times for direct services operating out of Cambridge and St. Neots railway stations together with interchange destinations.

**Train Services from St Neots and Cambridge**

From	To	Per Hour	Journey Time	Operator
Cambridge	London King Cross	3	50-90 Minutes	Thameslink / Great Northern
Cambridge	London Liverpool Street	3	70-90 Minutes	Abellio Greater Anglia
Cambridge	Ipswich	1-2	80 Minutes	Abellio Greater Anglia
Cambridge	Birmingham	2	160 Minutes	Cross Country
Cambridge	Stansted	2	30-35 Minutes	Cross Country
Cambridge	Kings Lynn	1-2	45-50 Minutes	Thameslink / Great Northern
St Neots	London King Cross	2-5	45-70 Minutes	Thameslink / Great Northern
St Neots	Peterborough	2-5	24-30 Minutes	Thameslink / Great Northern



Rail information can be found at the below site:

[www.nationalrail.co.uk](http://www.nationalrail.co.uk)

**CAR SHARE**

Car-sharing (also called liftsharing, ridesharing and carpooling) is when two or more people share a car and travel together. It allows individuals to benefit from the convenience of the car, whilst reducing the costs and alleviating the associated problems of congestion and pollution.

<https://camshare.liftshare.com>

CamShare has been set up to provide a matching service for all those who live, work and travel in and around Cambridgeshire. This site matches you up with potential partners as a driver or passenger. Once matched, you can choose to journey share as little or as often as you like, with whoever you like!



Recommended safety measures to follow when considering a new car sharing partner:

- Avoid exchanging home addresses with your travelling companion before you meet them;
- Arrange to meet for the first time in a public place;
- Inform a friend or family member of who you will be travelling with, when and to where;
- Make sure you see each other's IDs - passports, student cards or driving licences - so you know you're travelling with the right person;
- You are under no obligation to go ahead with any car-share arrangement. If you have any doubts about your travelling companion, for any reason, then you don't have to travel with them.

## TAXI CARD SCHEME

If you experience difficulties with transport, the Cambourne Taxi Card Scheme may well solve your problems. The Cambourne Taxi Card Scheme is for people who have difficulties getting to or using public transport.

Those who do not have access to a car or any other means of transport can also use the scheme. Taxi Card vouchers offer travel with participating local taxi companies and Cambridge Dial-a-Ride at a subsidised rate. You can use the scheme to attend medical appointments, including Addenbrooke's or Hinchingsbrooke; shopping in Cambourne and Cambridge.

The scheme is simple to start and use. Firstly purchase booklets of vouchers in advance from Cambridgeshire County Council, telephone on 01223 717755. Vouchers cost 0.75 pence each and are available in booklets of 10 or 20. Each 0.75 pence voucher has a value of £2.50 (two pounds and fifty pence). You can then book a taxi with a participating company and use the vouchers to pay towards the fare. Vouchers can also be pooled together with other Taxi Card members to make journeys even cheaper.

For more information contact Gavin Moulton on 0345 045 1151 or by e-mail using the following address [community.transport@cambridgeshire.gov.uk](mailto:community.transport@cambridgeshire.gov.uk) or write to him at Cambridgeshire County Council, ET1015, Castle Court, Shire Hall, Cambridge CB3 0AP.



## USEFUL INFORMATION AND WEBSITES

### **Google Maps**

[www.maps.google.co.uk](http://www.maps.google.co.uk)

Get walking directions on Google maps. Click on 'Get Directions', then select the walking icon, put in your start and finish points, and select 'Get Directions' and your walking route will appear. You can also use this for public transport, cycling and driving directions.

### **Transportdirect.info**

[www.transportdirect.info](http://www.transportdirect.info)

Transport Direct is offers information for door-to-door travel which incorporates walking as part of a longer journey by public transport. The site provides comprehensive, easy-to-use travel information to help plan journeys effectively and efficiently.

Other useful information and travel websites are shown below:

### **Map of Cambourne**

[www.openstreetmap.org/export/embed.html?bbox=-0.07489,52.215,-0.06253,52.22199&layer=mapnik](http://www.openstreetmap.org/export/embed.html?bbox=-0.07489,52.215,-0.06253,52.22199&layer=mapnik)

### **Local Information Websites**

[www.cambournetravelplan.com](http://www.cambournetravelplan.com)

[www.cambourne.info](http://www.cambourne.info)

[www.cambourneconnection.co.uk](http://www.cambourneconnection.co.uk)

[www.cambourneforum.net](http://www.cambourneforum.net)

[www.cambourneparishcouncil.gov.uk](http://www.cambourneparishcouncil.gov.uk)

[www.cambournecrier.org](http://www.cambournecrier.org)

## TRAVEL PLAN COORDINATOR CONTACT DETAILS

**Contact:** David Fletcher - RPS  
**Tel:** +44 (0) 1235 432 190  
**Email:** [david.fletcher@rpsgroup.com](mailto:david.fletcher@rpsgroup.com)

THIS PAGE IS BLANK





CAMBOURNE

**Taylor**  
**Wimpey**

  
**BOVIS**  
**HOMES**

