

CAMBOURNE TOWN COUNCIL

District of South Cambridgeshire

ACTIVE TRAVEL SCHEME

Council Meeting 5th July 2022

In April an email was received from the Active Travel Scheme regarding a scheme to make Eastgate a one-way road. Please see the email below and attached drawings.

“We have been working on a scheme to make Eastgate one-way for traffic in order to provide a segregated cycle facility which will provide a safe route to the primary school. This is part of the Active Travel Tranche 2 government funded project. We were initially looking at one-way for traffic with a contra-flow lane for cyclists but as this would only really benefit those travelling east-west we have done some further work on the scheme to allow for a two-way segregated cycleway which links to the footway each end of Eastgate which we will look to widen. This would be undertaken under an Experimental Traffic Order which would allow for consultation during the first 6 months of the trial which can last up to 18months. If supported, it could then be made permanent. We have also contacted the school to gain their view of our proposals.”

- Notes**
- Do not scale from this drawing.
 - For all dimensions, the setting out dimensions shall be verified on site with any discrepancies reported to Matt Macdonald prior to proceeding.
 - The setting out dimensions shall be verified on site with any discrepancies reported to Matt Macdonald prior to proceeding.
 - For the purposes of installing proposed design arrangements only, if the setting out dimensions do not reflect the actual arrangement on site, the setting out dimensions shall prevail.
 - URS Investigation has not been undertaken during the development of this drawing. It is recommended that a survey be carried out to verify the proposed design arrangements prior to any excavation works.

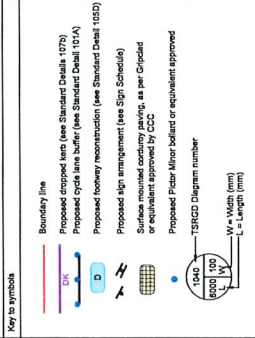

Location Plan - Scale 1:10000

Rev	Date	Drawn	Description	Checked	App'd
01	01/04/2022	MS	Approved Scheme	MS	MS
02	01/04/2022	MS	Revised Scheme	MS	MS
03	01/04/2022	MS	Final Scheme	MS	MS
04	01/04/2022	MS	Final Scheme	MS	MS
05	01/04/2022	MS	Final Scheme	MS	MS
06	01/04/2022	MS	Final Scheme	MS	MS
07	01/04/2022	MS	Final Scheme	MS	MS
08	01/04/2022	MS	Final Scheme	MS	MS
09	01/04/2022	MS	Final Scheme	MS	MS
10	01/04/2022	MS	Final Scheme	MS	MS

M M
MOTT MACDONALD
 Matt Macdonald
 Cambridge, CB1 2JD
 United Kingdom
 T +44 (0)1223 463 500
 F +44 (0)1223 461 507
 W mottmac.com



Cambridgeshire Active Travel
Eastgate, Cambourne - S02
General Arrangement
Sheet 1 of 3

Designed	J.M.M.	Eng check	C.Kweek	CK
Drawn	D.Dyball	Coordination	C.Kweek	CK
Draw check	K.Zwolak	Approved	O.Darham	OD
Scale at A1	1:250	Status	PRE	P4
Scale at A2	1:250	Rev	P4	STD
Scale at A3	1:250	Security		

Drawing Number
100100741-MMD-S02-XX-DR-C-0001

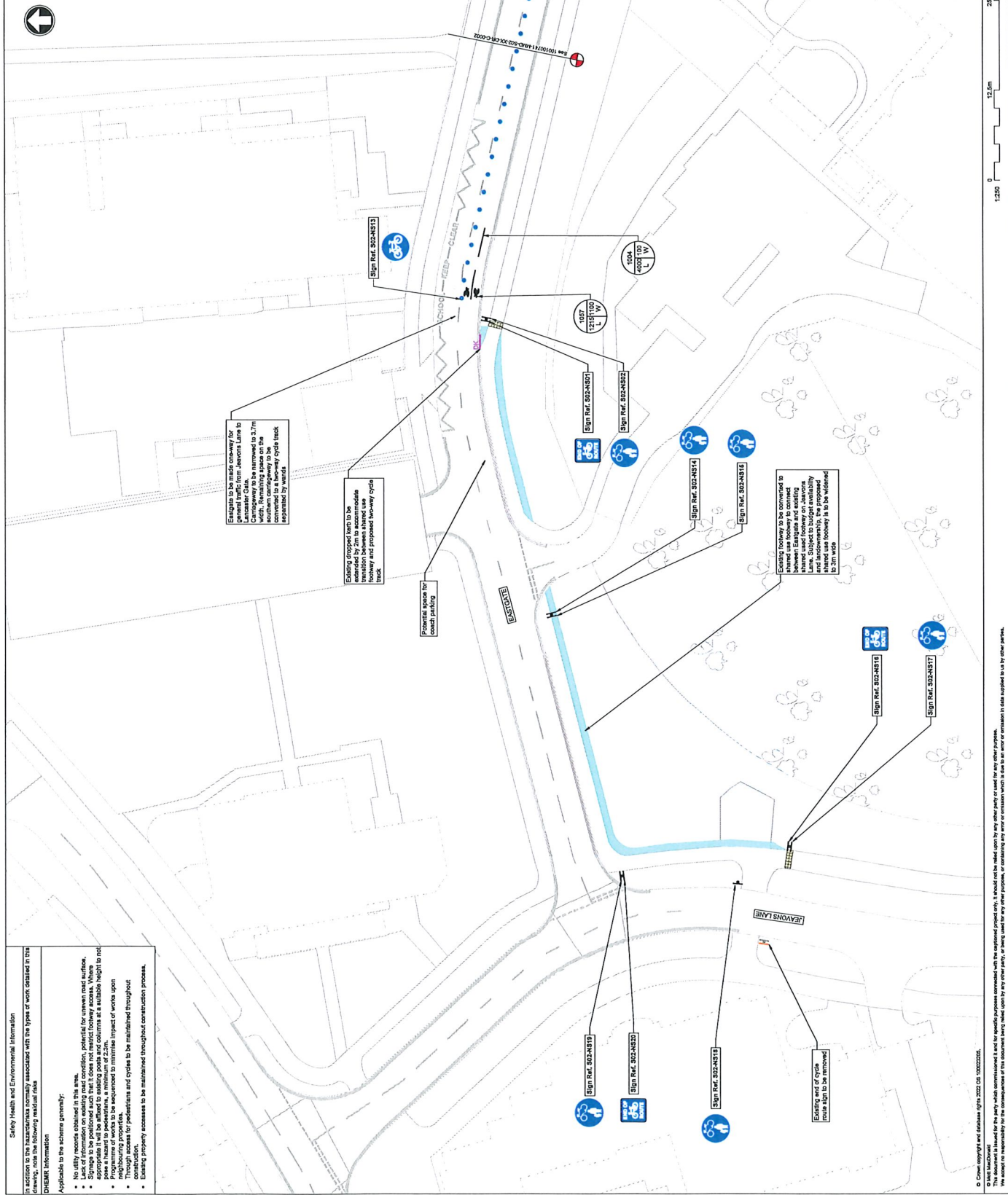

0 12.5m 25m
 1:250
 © Cambridgeshire County Council 2022. All rights reserved.
 This document is issued for the party with whom it was prepared and is not to be used for any other purpose.
 The accuracy of the information is the responsibility of the client. The client is responsible for ensuring that the information is accurate and up to date.
 11/2022 - 11/2022

Safety Health and Environmental Information

In addition to the hazards normally associated with the type of work detailed in this drawing, note the following relevant risks:

CRITERIA INFORMATION

Applicable to the scheme generally:

- No utility records obtained in this area.
- Use of excavation on existing roads, footpaths, drains, sewers, water mains, gas, electricity, telecommunications, and other services. Where appropriate, it will be allowed to existing poles and columns at a suitable height to not affect the stability of the structure.
- Provision of access to be maintained to minimise impact of works upon neighbouring properties.
- Provision of access for pedestrians and cycles to be maintained throughout construction.
- Existing property accesses to be maintained throughout construction process.

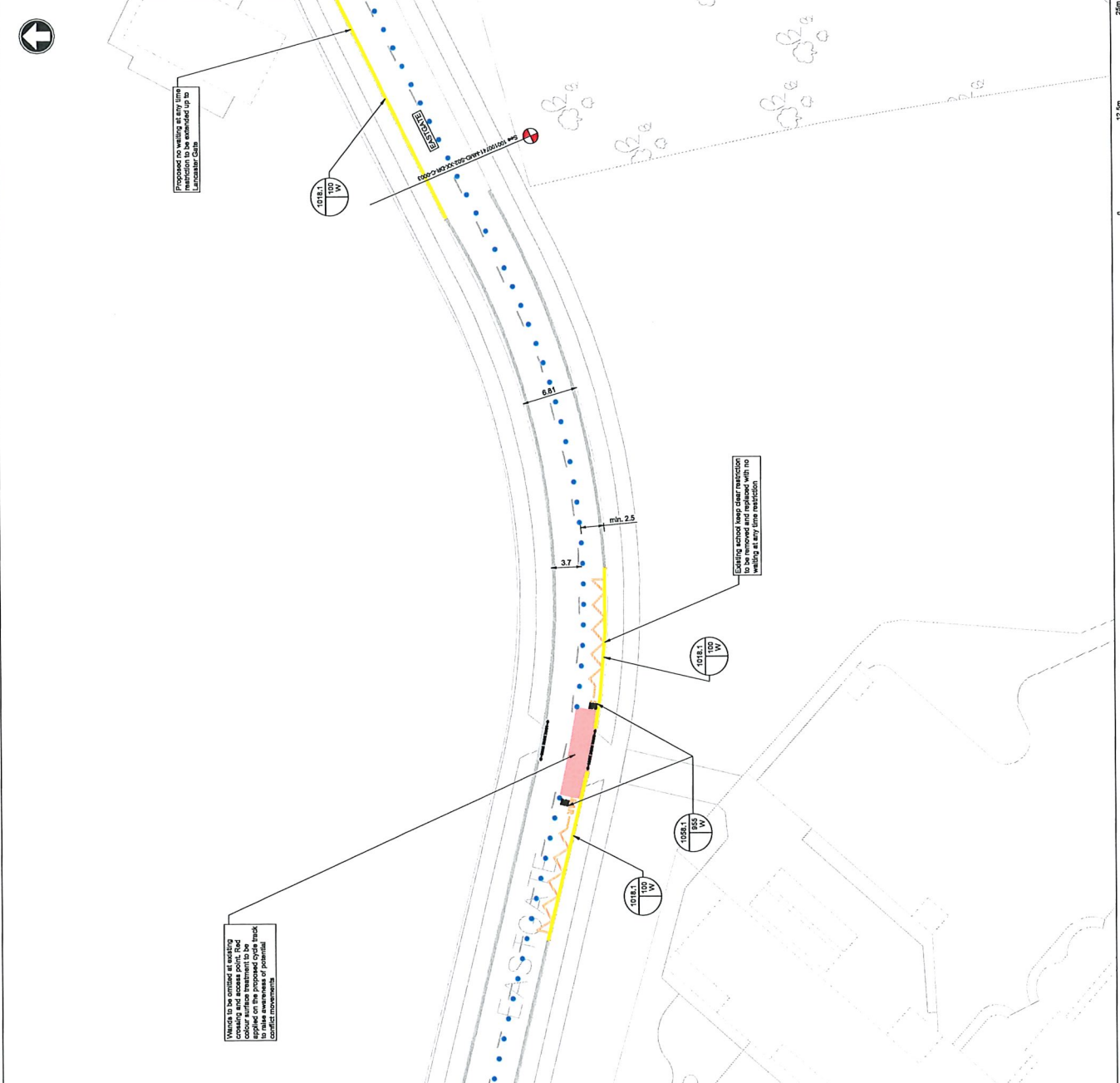

Notes

- Do not scale from this drawing.
- Check all dimensions against the applicable OS map(s) only.
- The setting out dimensions shall be verified on site with any discrepancies reported to Mott MacDonald prior to proceeding.
- Dimensions are shown in millimetres unless otherwise stated. All dimensions are for the purposes of illustrating proposed design arrangements only. If the existing arrangement does not reflect the actual arrangement on site, the dimensions shall form Mott MacDonald's best estimate of the proposed design.
- Utility investigation has not been undertaken to identify and address appropriate site surveys prior to any excavation works.

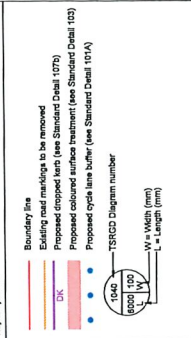

Location Plan - Scale 1:10000

Rev	Date	Drawn	Description	Checked	App'd
1	01/04/22	CE	Issue Issue	CS	DB

M M MOTT MACDONALD

Mott MacDonald
25 St Andrew Road
Cambridge, CB1 2JD
United Kingdom
T +44 (0)1223 463 500
F +44 (0)1223 461 507
W mottmac.com



Title
Cambridgeshire Active Travel
Eastgate, Camboorne - S02
General Arrangement

Design	J.Min	J.H	Eng check	C.Kew	L.K
Drawn	K.Zydek	A.Z	Coordination	C.Kew	L.K
Draw check	D.Dydek	J.D	Approved	O.Duffin	DB
Scale at A1	1:250	PRE	Rev	P1	STD
Status	1:250	PRE	Rev	P1	STD
Security					

Drawing Number
100100741-MMD-S02-XX-DR-C-0002

Safety, Health and Environmental Information
In addition to the responsibilities normally associated with the types of works detailed in this drawing, note the following residual risks:
DHEMR information
Applicable to the scheme generally:
• Use of excavation or similar ground excavation, potential for uneven road surface.
• Signage to be positioned such that it does not restrict footway access. Where possible, signage should be positioned at least 2.0m from the edge of the excavation and a minimum of 2.0m.
• Programme of works to be sequenced to minimise impact of works upon surrounding businesses and residents.
• Through access for pedestrians and cycles to be maintained throughout construction.
• Existing property accesses to be maintained throughout construction process.

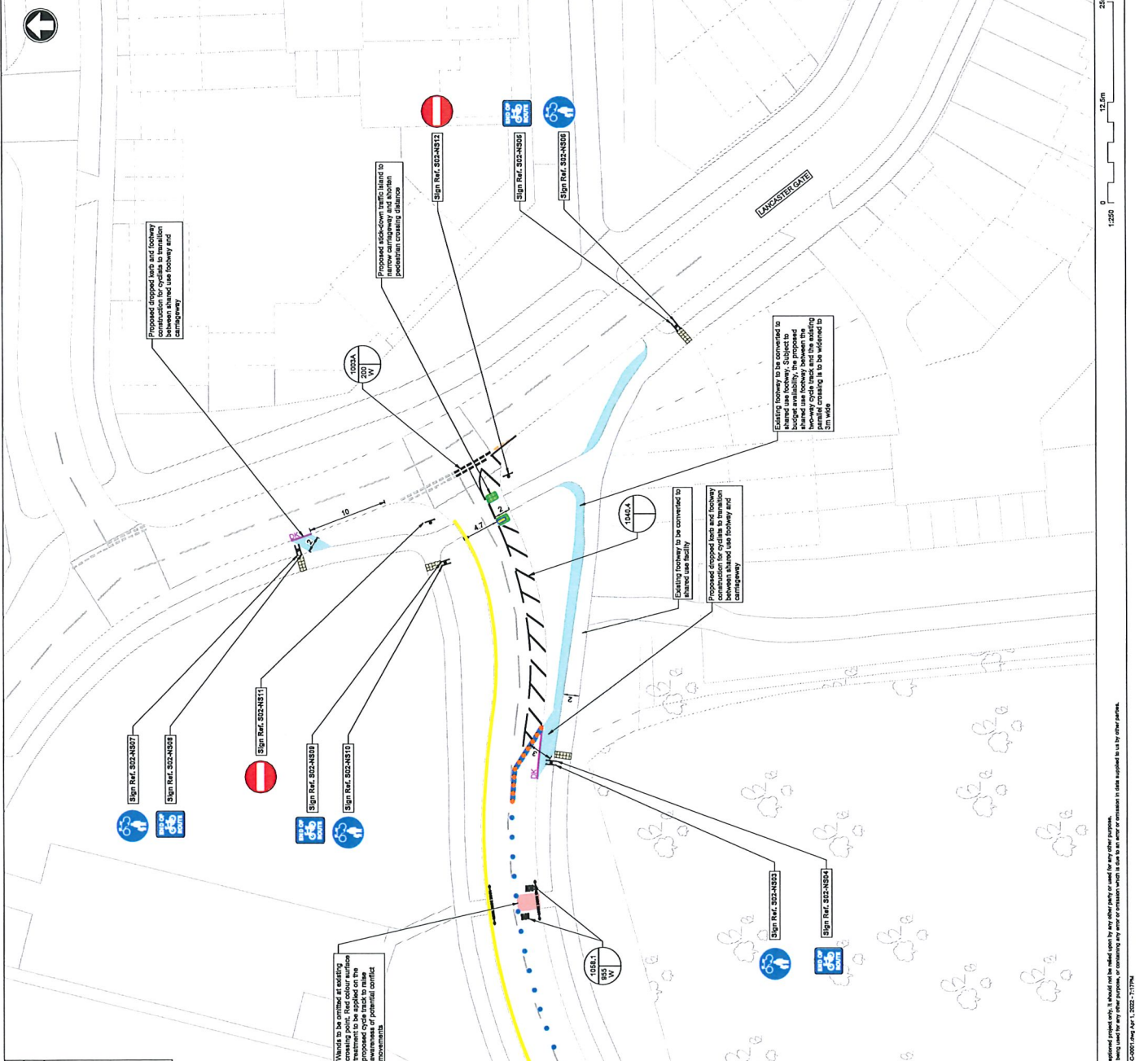

- Notes**
- Do not scale from this drawing.
 - The setting out dimensions shall be verified on site with any discrepancies reported to Mott MacDonald prior to proceeding.
 - Where necessary, the drawings are shown, they are indicative only and for the purposes of illustrating proposed design arrangements only. If the setting out dimensions do not reflect the actual arrangement on site, the contractor shall refer to Mott MacDonald team for further review prior to installation.
 - Utility investigation has not been undertaken during or subsequent to the surveys and any hidden utility services should be identified through appropriate site surveys prior to any excavation works.

Key to symbols

- Boundary line
- Existing road markings to be removed
- Proposed road markings (see Standard Detail 1014)
- Proposed ECRs and FC030 post (or equivalent approved, see Standard Detail 102)
- Proposed surface-mounted modular traffic island
- Proposed footway reconstruction (see Standard Detail 1020)
- Proposed sign arrangement (see Sign Schedule)
- Surface mounted corduroy paving, as per Gridpad or equivalent approved by CCC
- Surface mounted bollard with keep left symbol
- Proposed Plate for bollard or equipment approved

TSR60 Diagram number
W = Width (mm)
L = Length (mm)

Location Plan - Scale 1:10000

M M
MOTT MACDONALD
Mott MacDonald
Cambridge, CB1 2JD
United Kingdom
T +44 (0)1223 461 500
F +44 (0)1223 461 007
W mottmac.com

Client
Cambridgeshire County Council

Title
**Cambridgeshire Active Travel
Easigate, Cambourne - S02
General Arrangement
Sheet 3 of 3**

Designled	J.Man	J.W	Eng check	C.Kwok	CK
Drawn	K.Zydzik	AZ	Coordination	C.Kwok	CK
Draw check	D.Dryak	JD	Approved	O.Duffin	OD
Scale at A1	1:250	PRE	Rev	P1	STD

Drawings Number
100100741-MMD-S02-XX-DR-C-0003

© Crown copyright and database rights 2022 OS 100025265
This document is issued for the party which commissioned it and for specific purposes connected with the original project only. It should not be relied upon by any other party or used for any other purpose.
We accept no responsibility for the consequences of its use or for any other party, or being used for any other purpose, or containing any error or omission which is due to an error or omission in data supplied to us by other parties.
23/06/2022 7:45:00 PM MOTT MACDONALD 100100741-MMD-S02-XX-DR-C-0003.dwg (P. 1, 2022 - 1:17 PM)