

CAMBOURNE TOWN COUNCIL

District of South Cambridgeshire

Council Meeting 1st August 2023

Traffic Matters and Road Safety

Correspondence

	FROM	SUBJECT
15.1	Clare Rankin- Cambridgeshire County Council	Zebra crossings

The below schedule is a summary of correspondence circulated by the Town Clerk to Councillors since the last meeting by email

FROM	SUBJECT
Greater Cambridge Partnership	Making Connections update
Cambridgeshire County Council	PR0951 Proposed 20mph Speed Limit Zones and 30mph Speed Limit - Various Roads, Cambourne
Greater Cambridge Partnership	Engagement opens on Fulbourn Greenway Phase 1: Eastern Section

15.1 Zebra Crossings

Dear John,

As you are aware we have been investigating the possibility of installing a zebra crossing on Jeavon's Lane. We looked at moving the crossing slightly further south so it would be within the adopted highway but discovered that the verges aren't adopted all the way down Jeavons Lane – we would need to use the verges within the crossing area as footway and installation of belisha beacons. I've been in contact with the developers (Vistry) who said that '*a land transfer of the verges to the Town Council is currently in progress but we don't have any timescales at the moment as they are tied into the transfer of a much larger parcel of land*'. We therefore can't proceed with this scheme unless there is more info on adoption happening soon as the developers would not be prepared to take on liability or maintenance of the works on their land.

This leaves the build out crossing further south on Jeavon's Lane and the zebra crossing next to the Jeavon's Wood School – see attached plan. Please could you get back to me re:

- 1) Is the Town Council supportive of the implementation of the zebra crossing on Eastgate, next to the school? We would look to undertake the works during the October half term to minimise disruption.
- 2) Is the Town Council supportive of the implementation of the build out to slow traffic and facilitate crossing movements on Jeavon's Lane, south of the junction with Eastgate
- 3) Does the Town Council have any funding it could contribute towards the works - we have some funding but the budget is tight and we may not be able to proceed with the zebra and the build out. Once we have undertaken trial holes and ground surveys we'll have more certainty over cost.

The other option is not to proceed with the elements above and wait for adoption, however there is no guarantee that the funding will still be available at this point.

I look forward to hearing the views of the Town Council.

Best regards

Clare

Clare Rankin
Project Manager
Cambridgeshire County Council

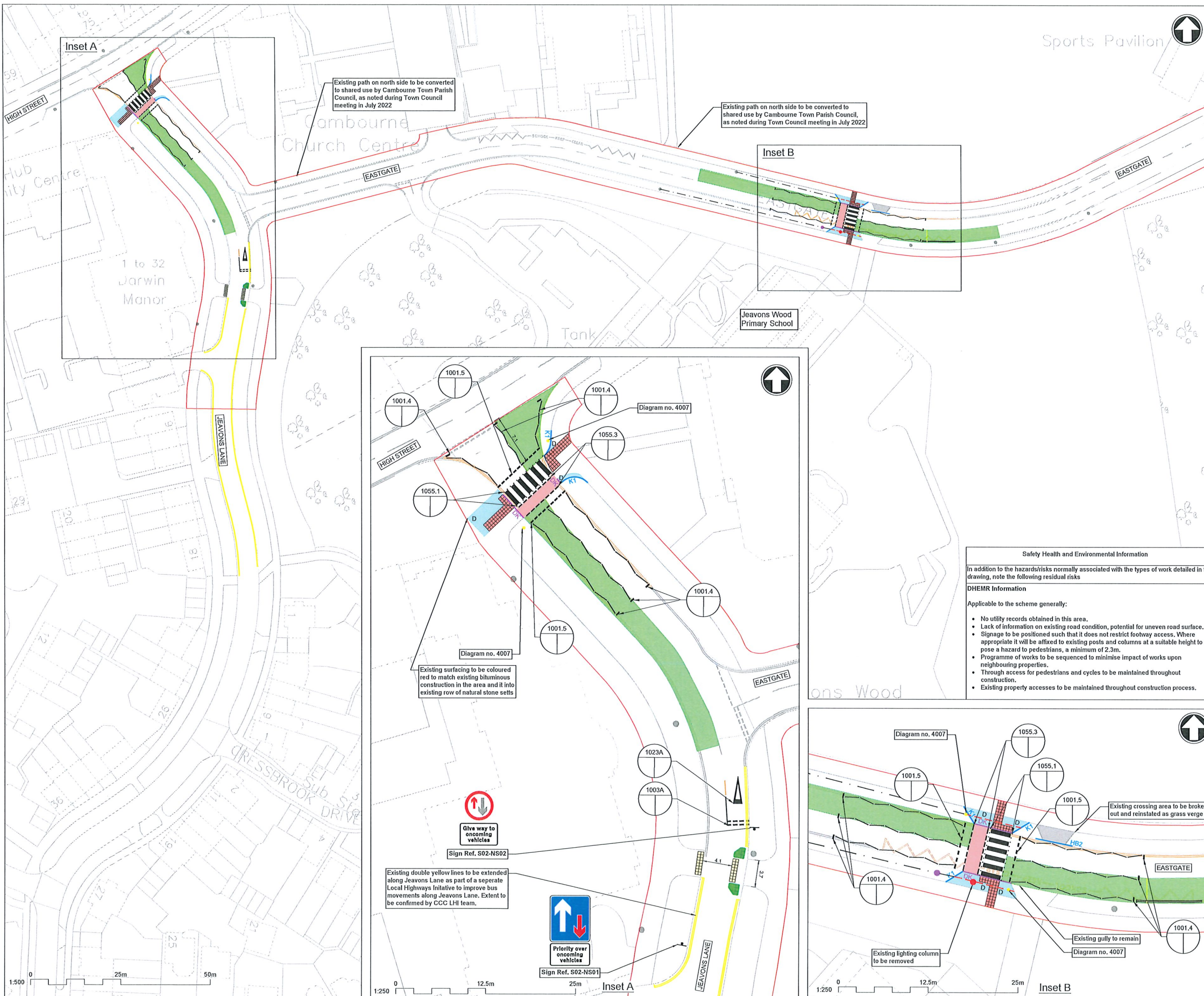

- Notes**
- Do not scale from this drawing
 - The proposed design is based on available OS mapping only
 - The setting out dimensions shall be verified on site with any discrepancies reported to Mott MacDonald prior to proceeding
 - Where existing road markings and street furniture are shown, they are indicative and for the purposes of illustrating proposed design arrangements only. If the existing arrangement does not reflect the actual arrangement on site, the Contractor shall inform Mott MacDonald team for further review prior to installation
 - Utility investigation has not been undertaken during the development of the design. The Contractor shall obtain utility records and undertake appropriate site surveys prior to any excavation works.
 - All dropped kerbs will have a transition kerb installed at either side.

- Key to symbols**
- Boundary line
 - Proposed kerb (see standard detail 107a)
 - Existing features (grey circles denotes existing lighting columns)
 - Existing road markings to be removed (Red circles denotes existing lighting column to be removed)
 - Proposed dropped kerb (see Standard Detail 107b)
 - Proposed coloured surface treatment (see Standard Detail 103)
 - Proposed sign arrangement (see Sign Schedule)
 - Proposed yellow globe
 - Proposed blister (buff) tactile paving (see Standard Detail 108)
 - Proposed blister (red) tactile paving (see Standard Detail 108)
 - Proposed surface-mounted modular traffic island (See Standard Detail 108d)
 - Proposed footway reconstruction (see Standard Detail 105D)
 - High Friction surfacing to be applied for 40m in advance of crossing. Buff Calcined Buxite Aggregate with PSV of 68+
 - Assumed position of existing LV cable supplying existing lighting columns to supply new lighting columns
 - Assumed position of existing LV cable supplying existing lighting columns which may require localised lowering by 100mm
 - TSRGD Diagram number
 - New lighting column. Refer to Street lighting drawing 100100741-MMD-S02-XX-DR-C-1300 for details
 - W = Width (mm)
 - L = Length (mm)

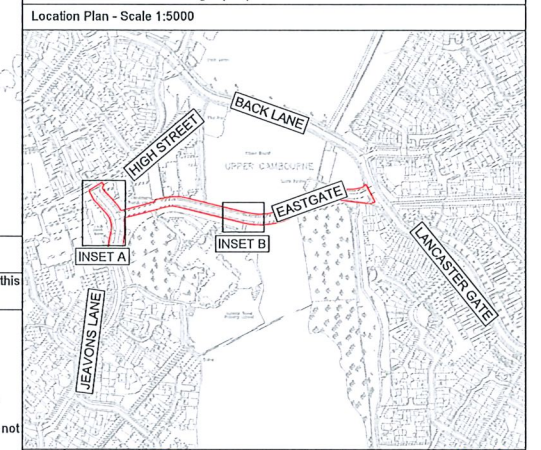

Safety Health and Environmental Information

In addition to the hazards/risks normally associated with the types of work detailed in this drawing, note the following residual risks

DHEMR Information

Applicable to the scheme generally:

- No utility records obtained in this area.
- Lack of information on existing road condition, potential for uneven road surface.
- Signage to be positioned such that it does not restrict footway access. Where appropriate it will be affixed to existing posts and columns at a suitable height to not pose a hazard to pedestrians, a minimum of 2.3m.
- Programme of works to be sequenced to minimise impact of works upon neighbouring properties.
- Through access for pedestrians and cycles to be maintained throughout construction.
- Existing property accesses to be maintained throughout construction process.

Rev	Date	Drawn	Description	Ch'k'd	App'd
P2	10/01/23	KZ	Updated to incorporate lighting design	CK	OD
P1	10/08/22	KZ	RSA comments incorporated	CK	OD

MOTT MACDONALD

Mott MacDonald
 22 Station Road
 Cambridge, CB1 2JD
 United Kingdom

T +44 (0)1223 463 500
 F +44 (0)1223 461 007
 W mottmac.com

Client

Cambridgeshire County Council

Title

Cambridgeshire Active Travel
 Eastgate, Cambourne - S02
 General Arrangement

Designed	R.Spinner	RS	Eng check	C.Kwok	CK
Drawn	K.Zvolak	KZ	Coordination	C.Kwok	CK
Dwg check	D.Dydak	DD	Approved	O.Daffarn	OD
Scale at A1	Status	Rev	Security		
1:500	PRE	P2	STD		

Drawing Number

100100741-MMD-S02-XX-DR-C-0004